

KORE LOCK

Cold & Warm Pitched Roof Insulation

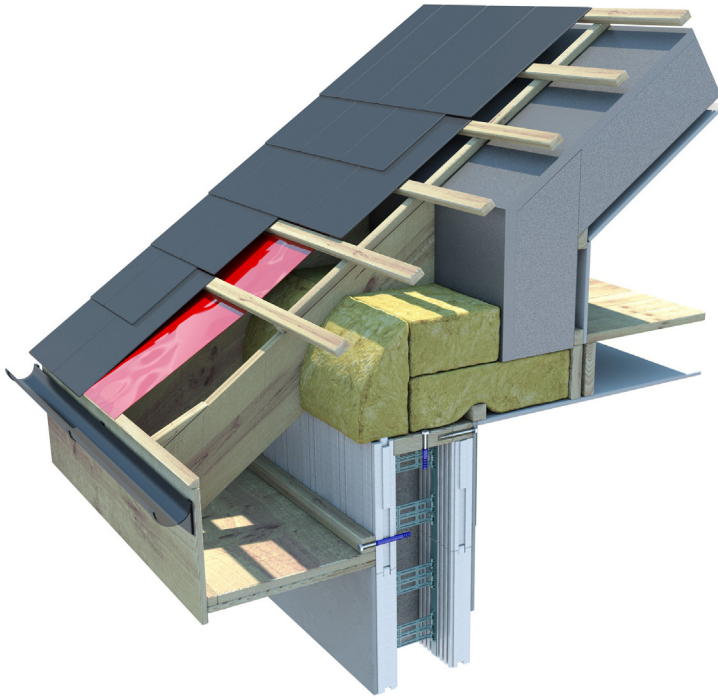

Part L Compliance is Easy

Warm Roof - 100mm KORE Lock EPS70 Silver plus 100mm KORE Warmsark EPS100 Silver = 0.16W/m²K

Cold Roof - 175mm KORE Lock EPS70 Silver plus 50mm KORE Thermal Board EPS70 Silver = 0.16W/m²K

Looking for Passive Values? It's easier to achieve with a warm roof application

Warm Roof - 200mm KORE Lock EPS70 Silver plus 100mm KORE Warmsark EPS100 Silver = 0.16W/m²K

Thermal Conductivity

EPS70 Silver = 0.031W/mK

EPS100 Silver = 0.031W/mK

Where to Install

- KORE Lock is installed between the joists or rafters
- KORE Warmsark is installed over the rafters externally
- KORE Thermal Board is installed under the rafters internally

Why Install KORE Lock

- KORE Lock insulates with air, not gas
- KORE Lock has variable width adjustment for easy installation
- Compliance with building regulations is simple
- Thermal performance will not diminish over time
- KORE Lock easily facilitates all roof ventilation requirements.



A product of **AIRPACKS**

How to Install KORE Lock

We offer a detailed installation guide available on the KORE website and the KORE Resource Centre. Join the KORE Resource Centre at no cost and receive access to our full technical library, including installation guidelines, design guidelines, declaration of performance certificates, U-value and condensation risk calculations and typical construction details.

Sign up today by visiting docs.kore-system.com

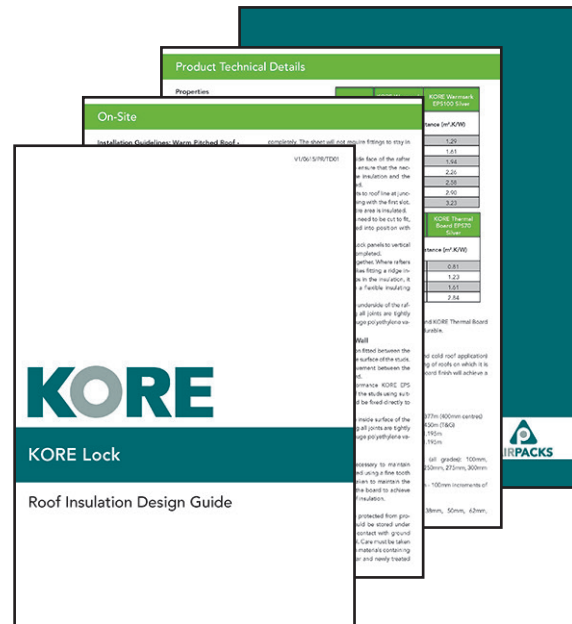

Buy with Confidence



- Buy an independent certified product - our product certification number is NSAI Irish Agreement Certification Number 05/0235
- Buy a product manufactured to an independent certified quality management programme - our manufacturing process is certified to ISO 9001 2008 QMS

Quality Assurance

KORE Silver Service

- Our team are here to help throughout the process
- We will calculate U-values and tell you what thickness and grade of our product you need to install, specific to your property
- We will perform a condensation risk analysis
- We can provide your architect with thermal bridging analysis results for typical junctions
- We can provide your architect with temperature factor analysis results for typical junctions
- We can visit the site and perform installation quality checks



BRE Green Guide awards KORE Lock with an A+ Environmental Rating

Airpacks Ltd. t/a KORE
The Green
Kilnaleck
Co. Cavan

T +353 49 4336998 E info@kore-icf.com
W www.kore-system.com
www.facebook.com/KOREIreland
Find us on Twitter @KORESystem