

KORELOFT

nZEB-Ready Insulated Attic Flooring System

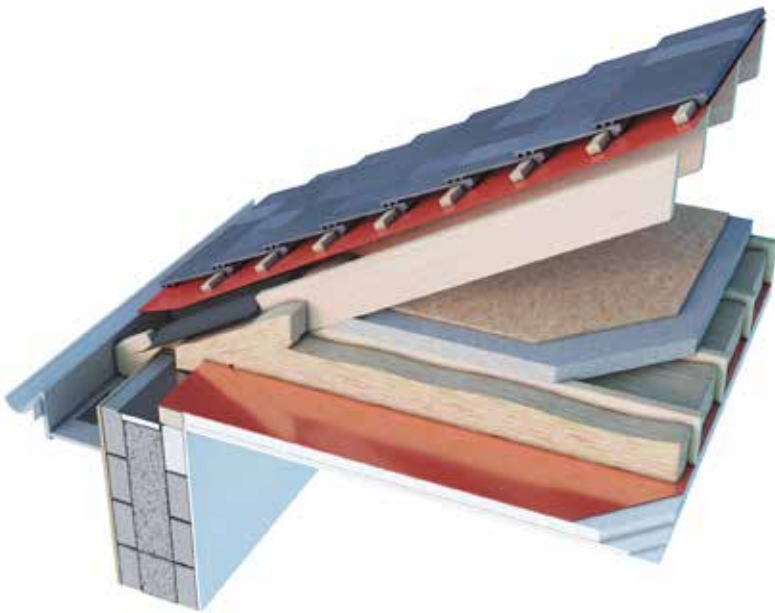

Meet & Exceed nZEB Requirements

KORE's EPS insulated attic flooring system has been designed to meet and exceed the U-value requirements of Part L 2021:

95mm KORE Loft EPS70 Silver plus
100mm mineral wool: $0.16W/m^2K$

KORE Solution	Thermal Conductivity
EPS70 Silver	$0.031W/mK$

Why Choose KORELOFT

KORE Loft is an insulated attic flooring system specifically designed to insulate the floor of an attic while still allowing ample space for storage and access to services

- KORE Loft insulates with air, not gas
- Compliance with building regulations, including nZEB, is simple
- Provides a safe means of access to the services and storage in the attic space
- Timber sheets are tongue and grooved for easy installation
- KORE Loft has excellent compressive strength
- Thermal performance will not diminish over time
- KORE Loft is durable, easy to work with and install
- KORE Loft is maintenance free

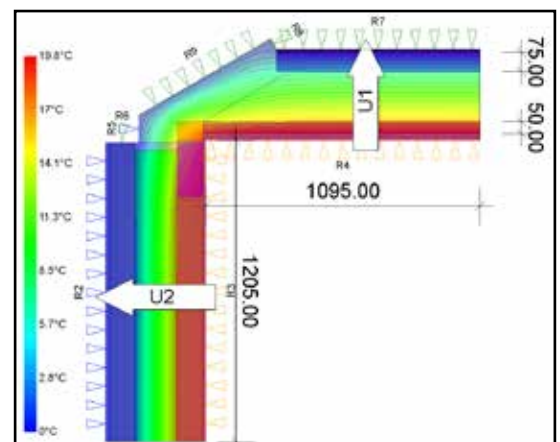

Psi Value - $0.066W/(mK)$
fRsi Value - 0.87

How to Install **KORELOFT**

KORE Loft is designed for installation in the attic space. It is installed over the joists in the attic to provide an insulated flooring system for safe access to storage and services in the attic.

We offer a detailed design guide available on the KORE website and KORE Resource Centre. Join the KORE Resource Centre at no cost and receive access to our full technical library, including installation guidelines, design guidelines, declaration of performance certificates, U-value calculations, typical construction details and BIM object files. Sign up today by visiting www.kore-system.com.



Guaranteed
Irish



KORELOFT Quality Assurance

- Buy a product manufactured to an independent certified quality management programme. Our manufacturing process is certified to ISO 9001:2015 QMS

KORE Technical Services

KORE's technical and sales teams have decades of combined experience in the insulation and construction industries. We partner with our customers, ensuring complete technical support - no matter the size of the project. Our services include:

- We can provide U-value calculations to determine thickness and grade of KORE EPS you need to install, specific to your property
- Condensation risk analysis
- We can provide you or your architect with thermal bridging analysis results for typical junctions
- We can provide you or your architect with temperature factor analysis results for typical junctions
- We can visit the site and perform installation quality checks
- We can provide you with a third-party verified Environmental Product Declaration for our EPS product range



BRE Green Guide awards KORE Loft with an A+ Environmental Rating



Designed to meet and exceed Ireland's Building Regulations Part L 2021. KORE Loft can be used towards achieving nearly zero energy building.