

# KORE INSULATED FOUNDATION

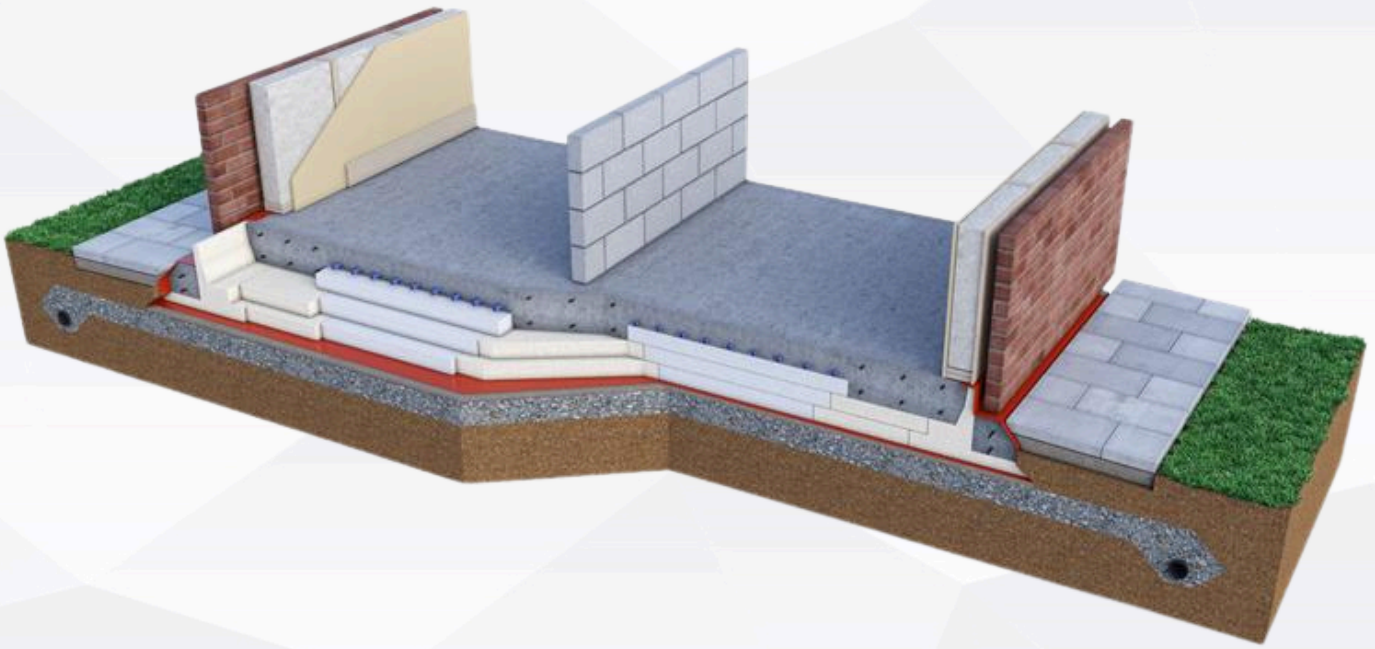

Enjoy a fully engineered system that offers U-values as low as 0.10W/m<sup>2</sup>K

## Who We Are



28 years in business



1,300 m<sup>3</sup> of EPS produced daily  
9,100 m<sup>3</sup> of EPS produced weekly



100+ Employees



10 insulation solutions available, including Low Carbon versions



62,000+ square foot production facility

## Benefits

- Delivers major on-site operational cost savings through efficiency and resource optimisation
- Planned in batches with defined start and end dates for a more organised and predictable build process
- Precision-engineered off-site to specification and delivered ready to install with a comprehensive guide
- Fully engineered by a chartered structural engineer and backed by BBA certification



# KORE INSULATED FOUNDATION

## HIGH PERFORMANCE INSULATED FOUNDATION SYSTEM

- Eliminates traditional block work below ground and keeps skilled labour in the superstructure
- Reduces machine time and machinery requirements; no digging trenches, less muck away
- Suitable for nearly all ground conditions, ideal for good or stabilised ground
- Reduces concrete use by approximately 40%, with just one pour required, significantly lowering embodied carbon
- Reduces waste to land fill from foundation construction, improving overall health and safety standards.



KORE's Insulated Foundation System has been designed to exceed UK-wide regulatory standards for energy efficiency and building fabric

**300mm EPS100 White: 0.10W/m2K**

Material	Thermal Conductivity
EPS100 White	0.036W/mK
EPS300 White	0.032W/mK

Assuming a P/A ratio of 0.4

## Save on Costs When Compared to a Traditional Foundation

Figures Provided to KORE Group by a Third Party

KORE's Insulated Foundation System can save up to 10% when compared to either a Traditional Strip Foundation or a Traditional Raft Foundation

\*Based on a typical semi-detached house design. Please contact us for a copy of the full cost comparison report.

# Build with a BBA Certified Foundation System- built for performance, not just compliance

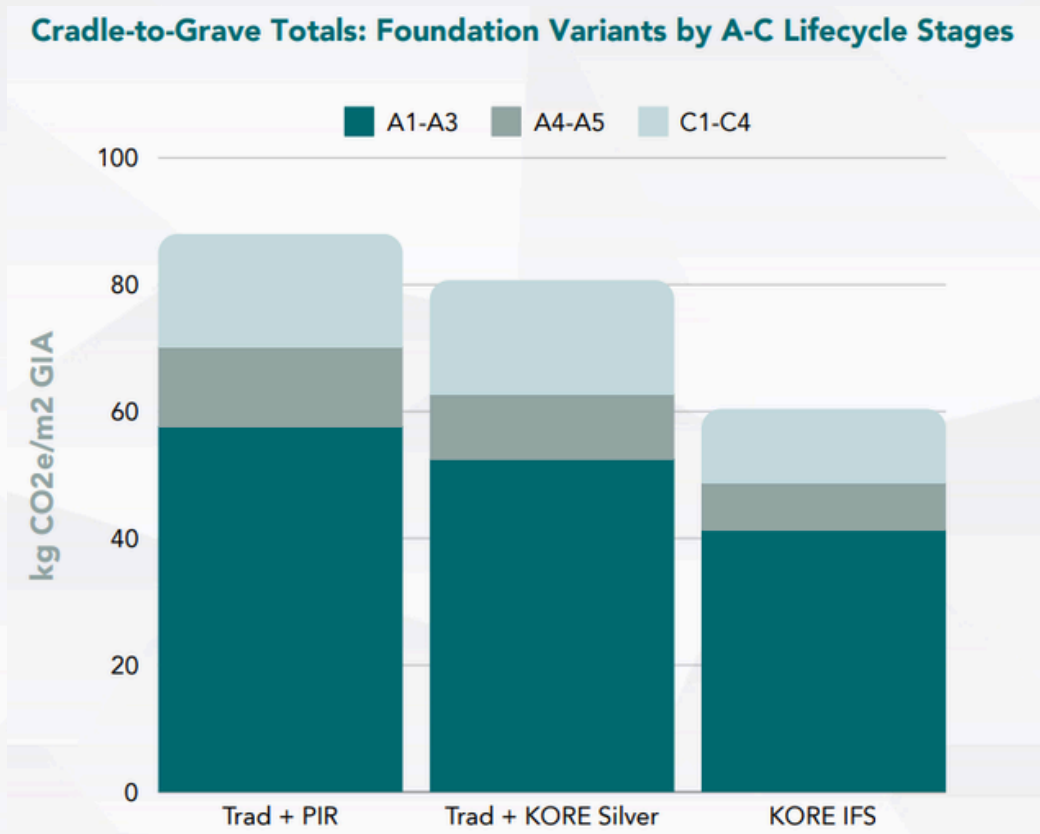

Life Cycle Stage	Traditional foundation + PIR (KG CO2e/m2 GIA)	Traditional foundation + KORE EPS70 Silver (KG CO2e/m2 GIA)	KORE Insulated Foundation System (KG CO2e/m2 GIA)
A1-A3	57.6	52.5	41.2
A4-A5	12.5	10.3	7.6
B1-B5	0.0	0.0	0.0
C1-C4	17.9	17.9	11.6
Total	88.1	80.8	60.3

## Our Commitment to Sustainability

Our EPS is sustainably manufactured, made of 98% air and holds a third party verified Environmental Product Declaration (EPD). The Insulated Foundation System reduces embodied carbon by up to 30%!

The system supports Passive and Low-Energy Building Standards, such as Passive Haus and MMC. All KORE's EPS is verified with the Global standard EcoVerify.

Exceptionally low embodied carbon, independently verified through EN 15804+A2 EPDs, reducing upfront emissions (A1–A5) in whole-life carbon assessments, supporting compliance with RICS WLCA, and aligning with RIBA 2030, LETI, and the emerging UK Net Zero Carbon Buildings Standard.

## Our Memberships

